

Yve offers the ultimate luxury lifestyle.

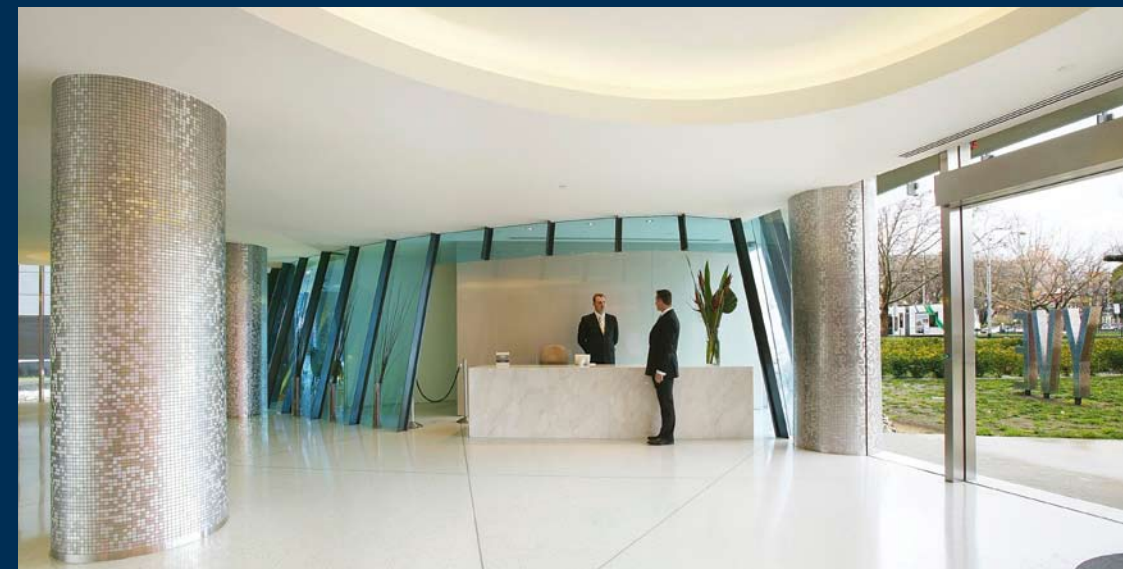

Yve Apartment 1004, St Kilda Rd

# Apartment 1004

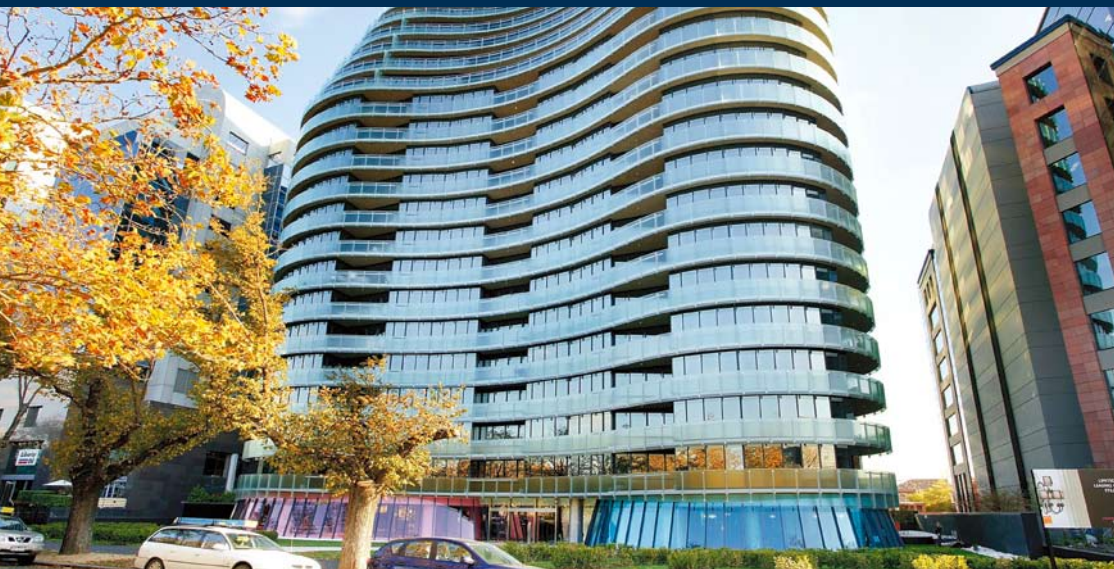

State of the art two bedroom apartment situated on the 10th floor in YVE complex. Offers open plan kitchen, lounge opening onto private balcony with uninterrupted views and master bedroom with plenty of robes & ensuite bathroom.



# Yve Facilities



Superb facilities include stunning indoor pool, spa, steamroom and sauna, huge light filled gymnasium, private cinema, residents lounge and business centre plus 24 hour concierge service



# Features

- 10th floor two bedroom apartment with balcony
- Open plan kitchen with stainless steel appliances including dishwasher
- Lounge opening onto private balcony with uninterrupted views. Master bedroom with plenty of robes & ensuite bathroom, central bathroom, second bedroom with BIR's.
- Superb facilities include stunning indoor pool, spa, steamroom and sauna, huge light filled gymnasium, private cinema, residents lounge and business centre plus 24 hour concierge service
- Secure parking
- Only minutes to CBD, Albert Park, shops & transport



Yve - Apartment 1004  
St Kilda Rd  
Melbourne

» 1300 625 626

Level 2, 2 Wellington Parade  
East Melbourne 3002

[www.moneychoice.com](http://www.moneychoice.com)